



# INSTRUCTION BULLETIN

No. 9008646  
Machine: 800  
Published: 01-2012  
Rev. 00

**NOTE: DO NOT DISCARD the Parts List from the Instruction Bulletin. Place the Parts List in the appropriate place in the machine manual for future reference. Retaining the Parts List will make it easier to reorder individual parts and will save the cost of ordering an entire kit.**

*NOTE: Numbers in parenthesis ( ) are reference numbers for parts listed in Bill of Materials.*

Installation instructions for **kit number 9008645**

## SYNOPSIS:

This kit contains the parts needed to replace hydraulic hoses and fitting on 800 machines.  
Please follow step-by-step instructions.

## SPECIAL TOOLS / CONSIDERATIONS: NONE

(Estimated time to complete: 2 hours)

## When assembling/disassembling hydraulic components:

1. Thoroughly clean outside of hydraulic components **before** disconnecting hydraulic hoses or fittings to prevent contaminants from entering system.
2. Cap disconnected hoses and open ports and flush hoses and fittings with air, solvent, or hydraulic fluid to prevent contaminants from entering system.
3. Mark hydraulic hoses with locations of where they are attached. Markings make it easier to reconnect hoses to proper locations.
4. Discard all hydraulic fluid drained from the system. Use only new approved hydraulic fluid to replenish hydraulic reservoir. Hydraulic fluid is potentially dangerous to the environment. Obey all federal, state, and local laws/regulations governing the disposal of environmentally hazardous materials when disposing hydraulic fluid.

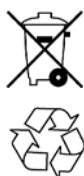

## PROTECT THE ENVIRONMENT

Please dispose of packaging materials, old machine components, and hazardous fluids in an environmentally safe manner according to local waste disposal regulations.

Always remember to recycle.

## PREPARATION:

1. Park the machine on a clean level surface, turn off the machine, remove the key, and set the parking brake.

**FOR SAFETY: Before leaving or servicing machine, stop on level surface, turn off machine, and remove key.**

## INSTALLATION:

1. Open both the engine top cover and engine side cover
2. Remove the access cover located on the seat support panel from the operator compartment. Set the access cover and hardware aside. (Fig. 1)



FIG. 1

3. Cut all cable ties securing the drive hoses to other hoses and the nylon sleeve. Note approximate locations of all cable ties. New cable ties will need to be installed in the same locations after new hydraulic hoses are installed.
4. Remove the channel retainer securing the drive hoses into place from the machine. Set the retainer and hardware aside. Leave the cable clamp hang on the smaller hose routed along the drive hoses. (Fig. 2)

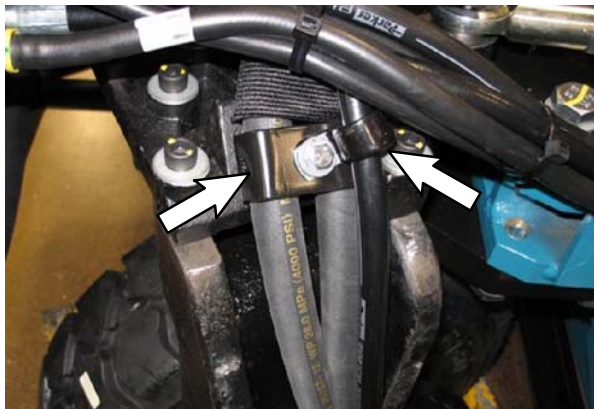

FIG. 2

**FOR SAFETY:** When servicing machine, chock machine tires before jacking machine up. Use a hoist or jack that will support the weight of the machine. Jack machine up at designated locations only. Support machine with jack stands.

*NOTE: Refer to MACHINE JACKING in the MAINTENANCE section of the Operators manual for additional safety information.*

5. Chock the front and back of both front tires.
6. Jack up the back end of the machine until the rear tire is approximately 9" off the floor.
7. Place jack stands under the back end of the machine.
8. Disconnect the drive hoses from the hydraulic pump. (Fig 3 / Fig. 5)



FIG. 3

9. Disconnect the drive hoses from the rear wheel hydraulic gear motor and pull the drive hoses from the machine. (Fig 4 / Fig. 5)

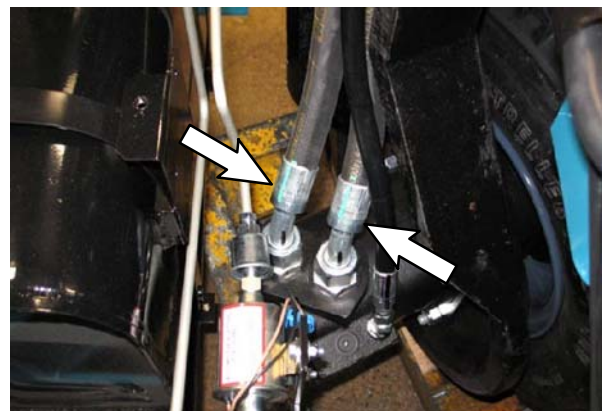

FIG. 4

10. Remove the nylon sleeve from the drive hoses. Set the nylon sleeve aside. Discard the drive hoses. (Fig. 5)

11. Remove the 90° hydraulic fittings from the hydraulic pump and the straight hydraulic fittings from the rear wheel hydraulic gear motor. Discard the removed fittings. (Fig. 5)

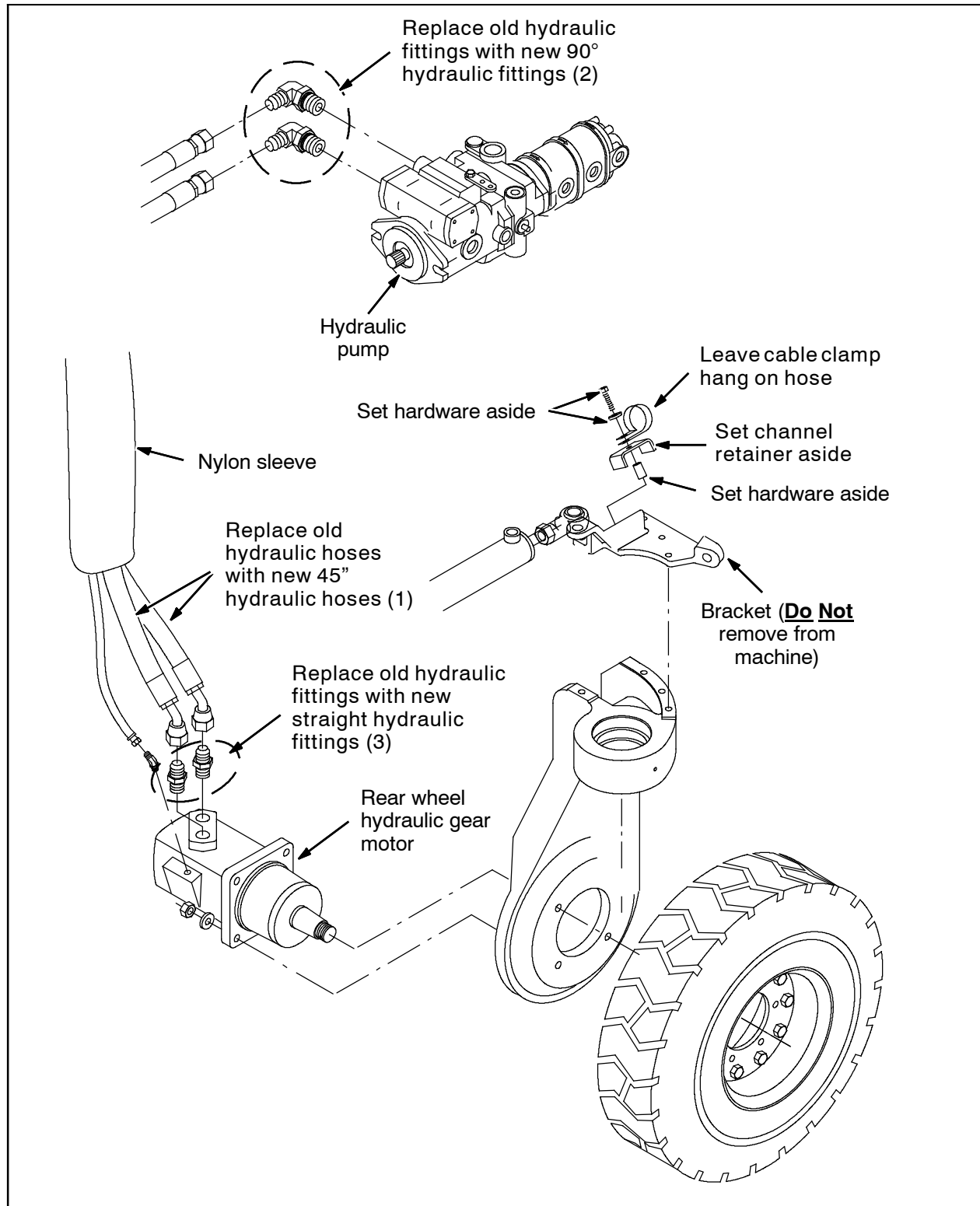
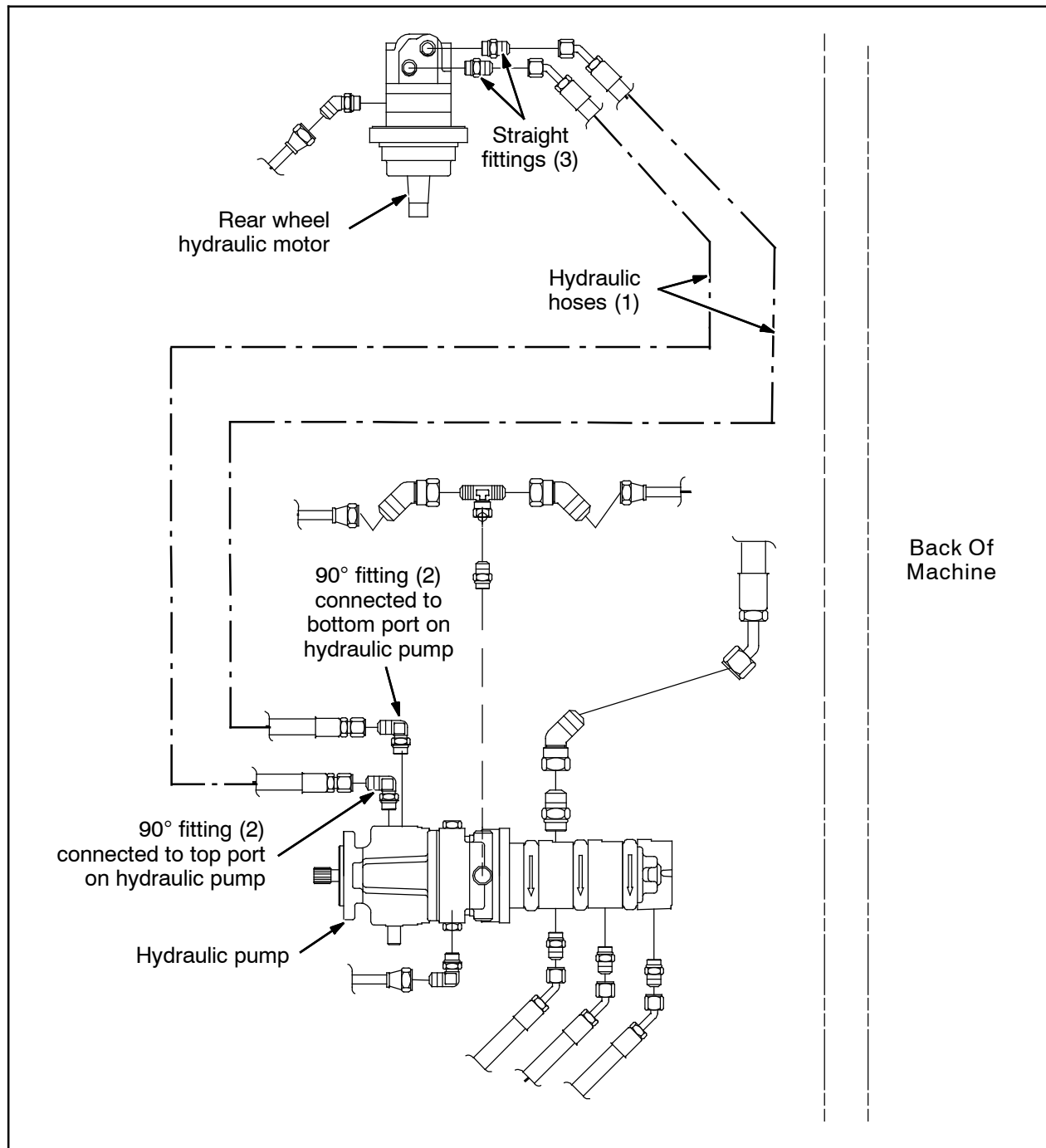

FIG. 5



**FIG. 6**

12. Install both straight fittings (3) onto the rear wheel hydraulic motor. (Fig. 6 / Fig. 5)
13. Install both 90° fittings (2) onto the hydraulic pump. (Fig. 6 / Fig. 5)
14. Use a permanent marker to mark both ends of one of the new hydraulic hoses (1). Hydraulic hoses must be connected to corresponding ports on the rear wheel hydraulic drive motor and the hydraulic pump. (Fig. 6 / Fig. 5)
15. Connect both hydraulic hoses (1) to the rear wheel hydraulic drive motor. (Fig. 6)
16. Slide the nylon sleeve onto both hydraulic hoses (1).
17. Route both hydraulic hoses (1) to the hydraulic pump. (Fig. 6 / Fig. 5)
18. Connect both hydraulic hoses (1) to the hydraulic pump. (Fig. 6 / Fig. 5)

19. Slide the sleeve on the hydraulic hoses (1) toward the hydraulic pump. (Fig. 5)
20. Reinstall the channel retainer and cable clamp onto the machine. (Fig. 7 / Fig. 5)

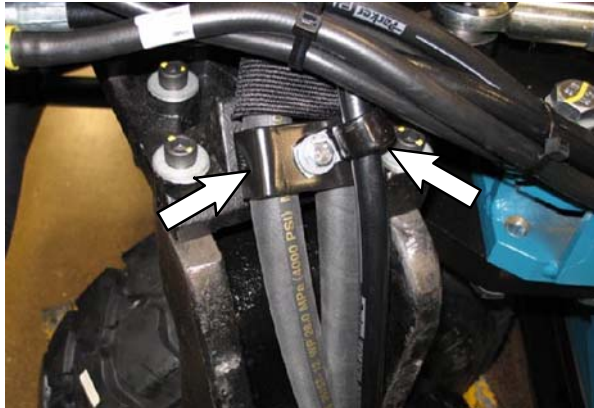

**FIG. 7**

21. Install cable ties onto the nylon sleeve and hydraulic hoses where the cable ties cut from the hoses and sleeve in Step 3 were previously located to secure the sleeve and hoses into place away from moving parts.

22. Remove the jack stands from under the machine and lower the machine to the floor.
23. Reinstall the access cover onto the operator compartment. Set the access cover and hardware aside. (Fig. 1)
24. Start and test the machine. Observe the newly installed fitting and hoses for leaks. Turn the steering wheel through the complete range of motion in both directions. Ensure the hoses are not binding or getting caught in moving parts when the machine is being steered.

---

**Bill Of Materials For Hose Kit, Rear Drive, Replmt - 9008645**

Ref.	Tennant Part No.	Description	Qty.
▽	9008645	Hose Kit, Rear Drive, Replmt	1
▲	1 1064170	Hose, Hyd, TC12, FF12E45/FF12STR, 045.0	2
▲	2 767407	Fitting, Hyd, E90, FM12/OM16	2
▲	3 79872	Fitting, Hyd, STR, FM12/OM16	2

TENNANT COMPANY  
P. O. Box 1452  
Minneapolis, MN 55440-1452